

30" X 30" X 8" S-126

FIRE HOSE CABINET SURFACE

STANDARD CONSTRUCTION FEATURES:

- Full Glass door (23" x 23" Panel Opening)
- Stainless Steel Paddle Latch
- Powder Coat Finish (Grey or White)
- Accommodates: 1 1/2" & 2 1/2" Valve
- Comes with 24"x 24" Plexi glass

- Front complete with Full Length piano hinge (14 ga. Construction)
- Universal Standpipe Knockouts (2" & 3")
- Tub (18 ga. Construction)

OPTIONS:

- 304 & 316 Stainless Steel Tub & Front (#4 Satin or #8 Mirror Finished Avail.)
- Break Glass Lock Assembly
- Full Metal Door
- Optional colours: Red or Yellow



75' - 100' Rack Hose

'5 - 10lb Dry Chemical Fire Extinguisher

FRONT

(Complete with Piano Hinge)

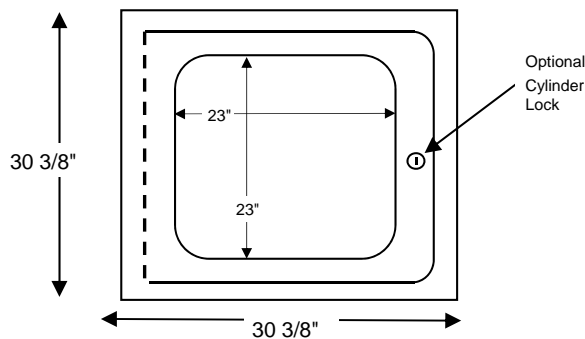

SIDE (1)

SIDE (2)

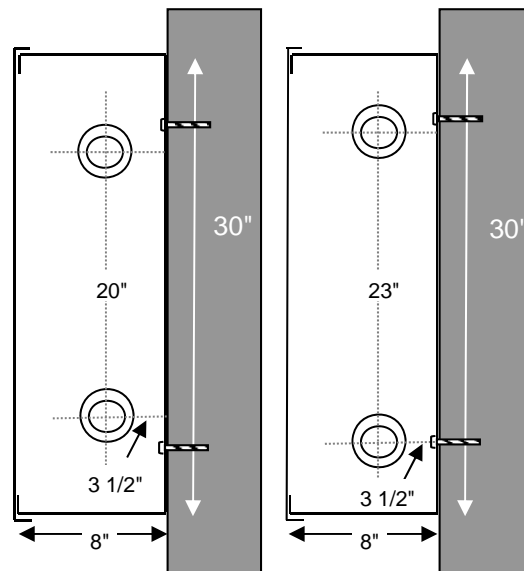

OPTIONAL STAINLESS STEEL FRONT

(Complete with Invisible SOSS Hinges & Full Metal Panel)

* Full Metal Door Shown

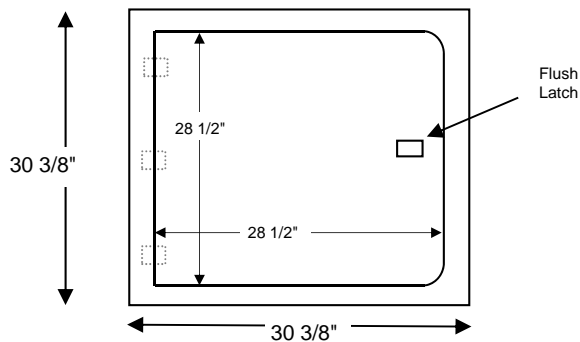

MADE IN CANADA

www.herbertwilliams.com

 **herbertwilliams**
FIRE EQUIPMENT LTD.