



## 1.5" Angle Valve with hydrolator Female NPT Inlet x Female NPT Outlet

Rough Brass AVF150, Polished Chrome AVF150-CHR



### Application:

- Used with swing hose racks with nipple and lock nut or as a department outlet connection
- 300 psi (2068 kPa) pressure tested approved
- 1-1/2" (38mm) angle hose valve with hydrolator may automatically drain and vent
- FM Approved & UL/ULC Listed

**Material:** Forged brass body and red iron handwheel

**Finish options:** Rough Brass, Polished Brass, Rough Chrome, Polished Chrome



### Dimensions:

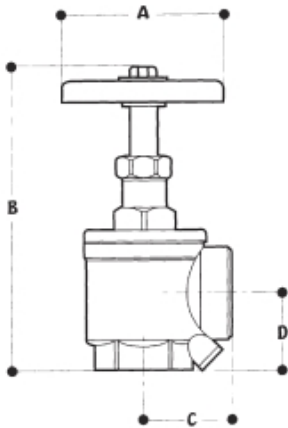

- A= 3.9" (98.5mm)
- B= 8.3" (OPEN) (211mm)
- B= 7.2" (CLOSED) ((183.1mm)
- C= 2.0" (52mm)
- D= 2.0" (51.8mm)